

Tolerancing NEN 2731(E) Tolerances acc. ISO 2768-mK-(E) / ISO 13920-AE	GPS - geometrical tolerancing acc. ISO 1101 Limits and fits acc. ISO 286	Surface texture acc. ISO 1302
---	---	-------------------------------

Title: **CRANEBLOCK WLL 20 Mtons [22 UStons]**

Rev. Description:	Drawn: LD	Date: 14-02-11	Projection:
	Checked: JE	Material: -	
	Units: mm	Theoretical weight: 254.2 kg	Sheet: 1 / 2
	Format: A3	Treatment: -	
Scale: 1:7	Drawing Number:	Revision:	
Rev. Date:	Rev. by:	FRB 355.19.1.20.E	01

Ropeblock code:	FRB 355.19.1.20.E	SWL/WLL:	20 Mtons [22 UStons]
Customer ID:	-	Dynamic factor:	-
Wire rope:	ø 19 mm [3/4"]	Load group:	1Bm DIN 15400
Hook size:	8P acc. DIN 15401	Design Acc.:	RB Standard, S.F. 4:1
Target weight:	± 250 kg [± 550 lbs]	Personnel lift SWL/WLL:	-

THIS DOCUMENT AND ALL INFORMATION AND DATA DISCLOSED HEREIN OR HEREWITH ARE THE CONFIDENTIAL AND PROPRIETARY PROPERTY OF ROPEBLOCK AND ARE NOT TO BE USED, REPRODUCED OR DISCLOSED IN WHOLE OR IN PART BY OR TO ANYONE WITHOUT THE WRITTEN PERMISSION OF ROPEBLOCK.

POS.	QTY.	Drawing Number	Title	Material
1	1	01.8.P.E.122	Single hook nr. 8 P acc. DIN 15401	StE 355
2	1	02.8.P.81112	HOOKNUT 8P - 81112	S355J2N
3	1	03.60.56.123.23	TRAVERSE KB 450.19.1.20	S355J2N
4	1	04G.355.5016.10	SHEAVE 355/80 R10 - MACHINING	GGG 50
5	1	05K.80.167	SHAFT ø80 FRB 355.19.1.20	34CrNiMo6
6	2	06.355.20.20	CHEEKPLATE FRB 355.19.1.20	S355J2N
7	2	07R.355.30.20	CHEEKWEIGHT FRB 355.19.1.20	S235J0
8	2	09.102.10.31,5	POS.RING FRB 355.19.1.20	S235J0
9	2	10.410.30.8	SPACERRING FRB 355.19.1.20	S235J0
10	1	11.60.123.35.37	BECKET SRB 355.1.16	S355J2N
11	2	12A.16.202	STUD KB 285.13.1.10	AISI 304
12	2	14.20.125.201	HINGEBAR KB 260.13.1.10	S355J0
13	1	15.36.188	BECKETPIN KB 450.19.1.18	C22
14	2	18.355.125	REEVEGUIDE KB 355.16.1.12.B	S235J0
15	1	19.200.125	TOPPLATE KB 260.13.1.10	S235J0
16	1	21.100.25.8	RETAINER 100x25x8	S235J0
17	1	41.15.15.40	NOTCH 15x15x40mm	S235J0
18	2	50.36.2	CIRCLIP 36 A - DIN 471	Steel
19	2	50.50.2	CIRCLIP 50 A - DIN 471	Steel
20	1	50.80.3	CIRCLIP 80 A - DIN 471	Steel
21	2	51.EV.16.200	BOLT M16x200 - DIN 931	8.8
22	1	54.5016PP	Bearing SL04-5016 PP	Steel
23	1	54.81112	Bearing 81112	Steel
24	6	55.EV.16	Nyloc Nut M16 - DIN 985	8.8
25	2	56.EV.08.20	BOLT M8x20 - DIN 933	8.8
26	1	61.95A	Dirtseal 95A	NBR
27	4	63.4	Safety pin ø4	Steel
28	1	64.8.E.B	Heavy duty safety latch kit for S8/D10 - DIN 15401/2	Acc. Spec.
29	3	66.10.01	Lubrication nipple M10x1 - DIN 71412	Steel

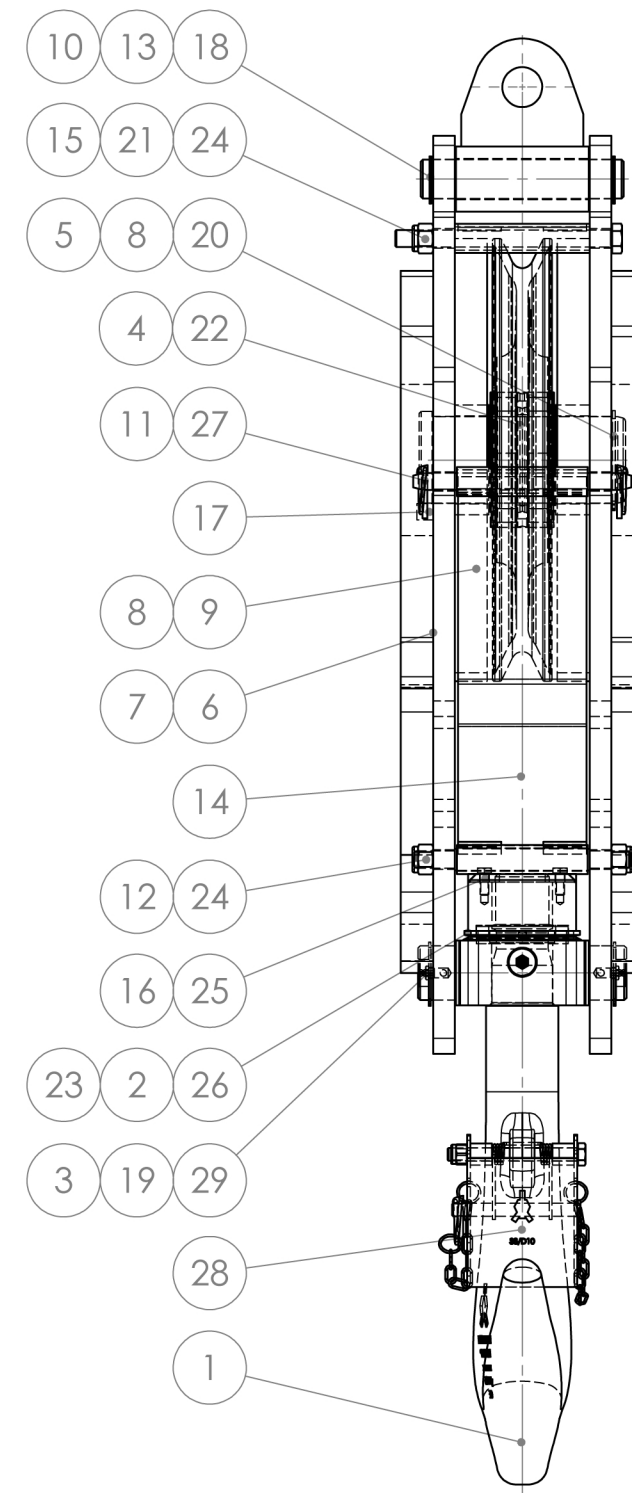

Tolerancing NEN 2731 (E) Tolerances acc. ISO 2768-mK-(E) / ISO 13920-AE		GPS - geometrical tolerancing acc. ISO 1101 Limits and fits acc. ISO 286	Surface texture acc. ISO 1302
Title: CRANEBLOCK WLL 20 Mtons [22 UStons]			
Drawn: LD	Date: 14-02-11	Projection: 	
Checked: JE	Material: -	Weight: 254.2 kg	
Units: mm	Treatment: -	Sheet: 2 / 2	
Format: A3	Scale: 1:7	Drawing Number:	Revision:
Rev. Description:	Rev. Date:	Rev. by:	FRB 355.19.1.20.E 01